

2

1

PARTS LIST

| ITEM | QTY | DESCRIPTION |
|------|-----|-----------------------------|
| (1) | 1 | AIMPOINT ACRO PLATE |
| (2) | 2 | #10-24, $\frac{3}{8}$ SCREW |

Tools Needed

- Torque wrench
- $\frac{3}{32}$ Hex bit for torque wrench
- T10 Torx bit for torque wrench
- T15 Torx bit for torque wrench

1. Install Adapter Plate

- Affix adapter plate (1) to Badger Ordnance ARC using screws (2). Torque to 35 in-lbs.

2. Install Aimpoint ACRO Sight

- With the ACRO recoil stop positioned in the recess, push the sight forward and tighten the locking bar screw.
- Tighten the locking bar screw until light resistance is encountered. Proceed with another $\frac{1}{4}$ - $\frac{1}{2}$ turn until fully tightened (torque to ≤ 26 in-lbs).
- Retighten the locking bar screw after initial firing to ensure sight is securely fastened.

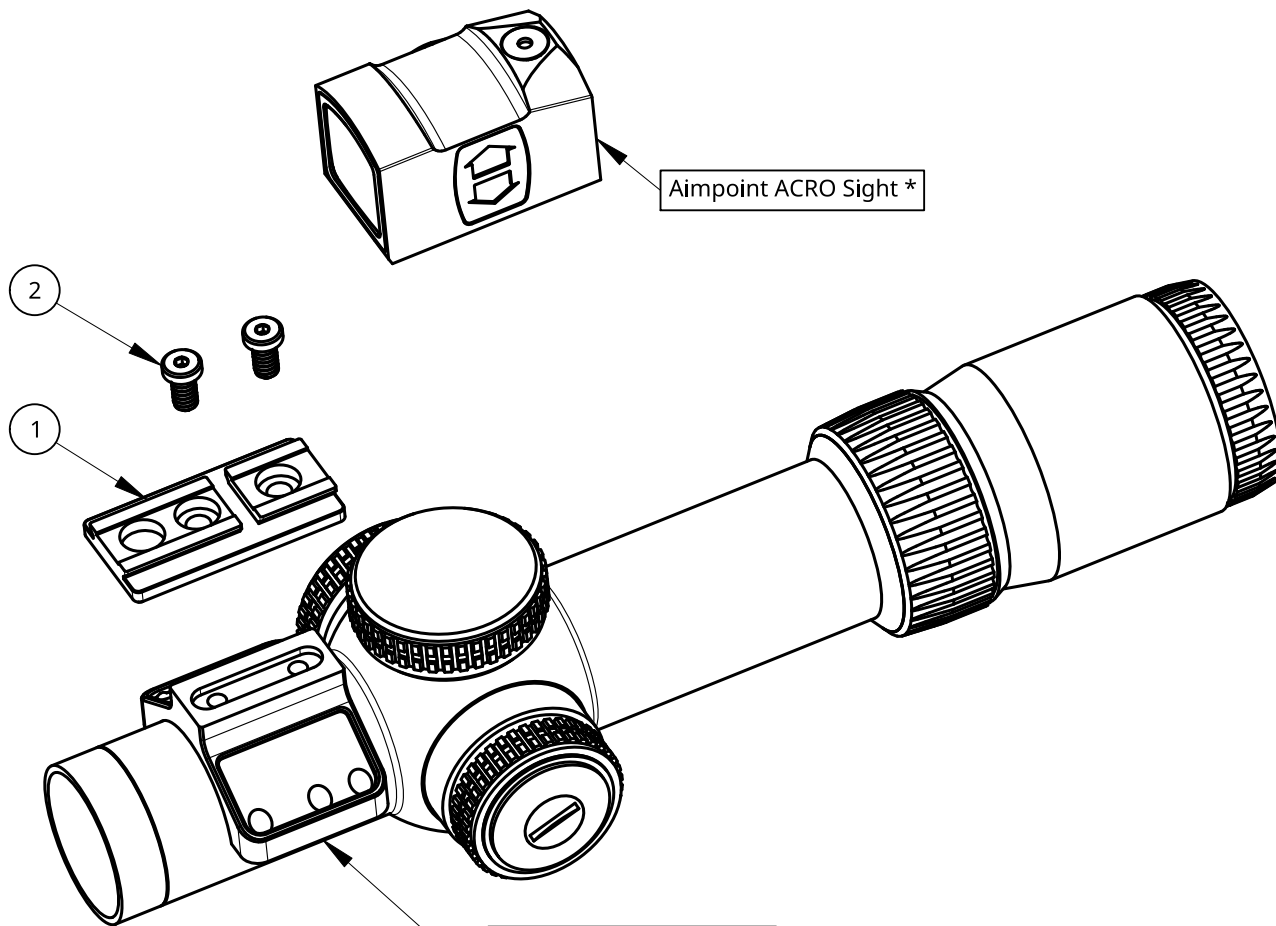

Badger Ordnance ARC **
 700-30 (30mm)
 700-34 (34mm)
 700-35 (35mm)

* Or other compatible sights with same mounting interface. E.g., Steiner MPS.

** Purchased separately.

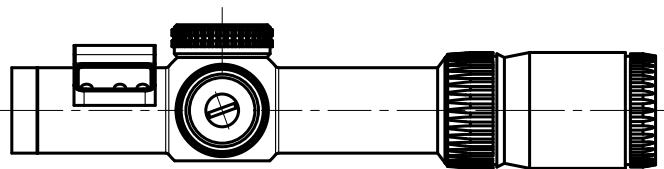
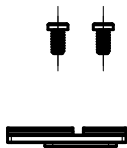

| | | | | | | | | | | |
|----------|--|----------|--|------------------------------|--|---|-------------|----------|--------|------|
| DRAWN | | NAME | | DATE | | KOENG PN 01-007 | | | | |
| CFC | | KOENG | | 03/20/2022 | | TITLE | | | | |
| CHECKED | | | | | | Aimpoint ACRO Adapter for Badger Ordnance C1 Mount | | | | |
| CFC | | | | | | SIZE | | DWG NO. | | REV. |
| APPROVED | | | | | | A | | 20220320 | | 01 |
| CFC | | | | | | SCALE | WEIGHT | SHEET | | |
| | | MATERIAL | | FINISH | | 1:1.5 | 12g / .45oz | | 1 of 1 | |
| | | 6061-T6 | | Mil. Spec Type 3 Anodized | | | | | | |

2

1