

2

1

PARTS LIST

| ITEM | QTY | DESCRIPTION         |
|------|-----|---------------------|
| (1)  | 1   | AIMPOINT ACRO PLATE |
| (2)  | 2   | #8-40, .205 SCREW   |

Tools Needed

- Torque wrench
- T10 Torx bit for torque wrench
- T15 Torx bit for torque wrench

1. Install Adapter Plate

- Affix adapter plate (1) to Leupold ring top in the desired position. The plate can be installed on either side at 45° angle or directly on top. The plate features multiple holes, so it can be placed farther forward or back.
- Once the desired position is determined, insert screws (2). Torque to 25 in-lbs.

2. Install Aimpoint ACRO Sight

- With the ACRO recoil stop positioned in the recess, push the sight forward and tighten the locking bar screw.
- Tighten the locking bar screw until light resistance is encountered. Proceed with another  $\frac{1}{4}$  -  $\frac{1}{2}$  turn until fully tightened (torque to  $\leq 26$  in-lbs).
- Retighten the locking bar screw after initial firing to ensure sight is securely fastened.

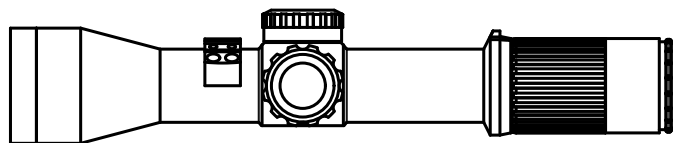
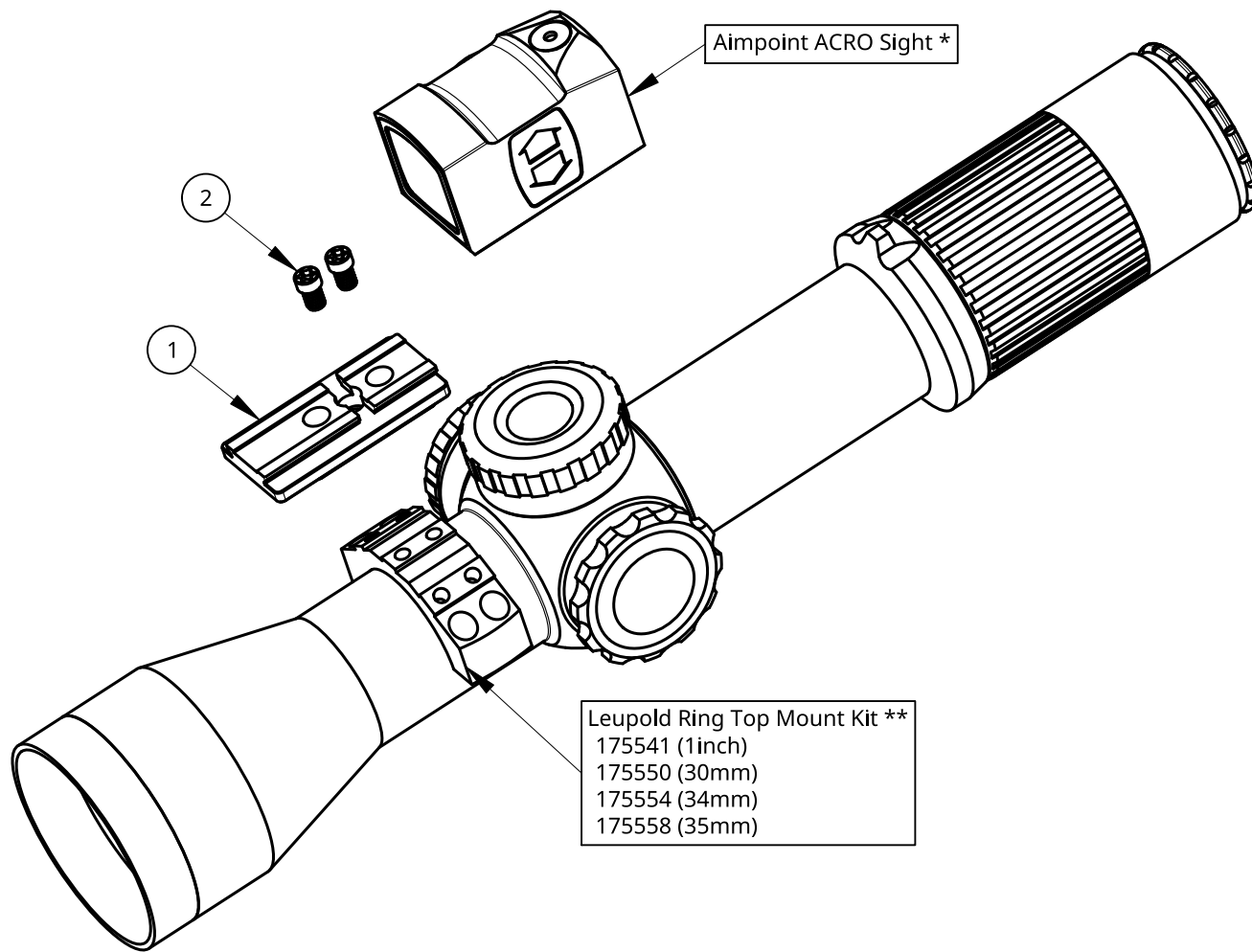

\* Or other compatible sights with same mounting interface. E.g., Steiner MPS.  
 \*\* Purchased separately.



|          |  |         |      |        |      |                           |  |       |   |         |          |      |    |
|----------|--|---------|------|--------|------|---------------------------|--|-------|---|---------|----------|------|----|
| DRAWN    |  | CFC     | NAME | KOENG  | DATE | 03/20/2022                | KOENG PN 01-008                                      |       |   |         |          |      |    |
| CHECKED  |  | CFC     |      |        |      |                           | TITLE  |       |   |         |          |      |    |
| APPROVED |  | CFC     |      |        |      |                           | Aimpoint ACRO Adapter for Leupold Ring Top Mount Kit |       |   |         |          |      |    |
| MATERIAL |  | 6061-T6 |      | FINISH |      | Mil. Spec Type 3 Anodized |  | SIZE  | A | DWG NO. | 20220320 | REV. | 01 |
| SCALE    |  | 1:1.5   |      | WEIGHT |      | 12g / .45oz               |  | SHEET |   | 1 of 1  |          |      |    |

2

1