

PARTS LIST

ITEM	QTY	DESCRIPTION
(1)	1	AIMPOINT ACRO PLATE PN 01-008
(2)	2	#8-40, .25 SCREW

This document fits an 8.5 x 11 US Letter sheet.
Document directory: <https://koeng.co/instructions/>

Document directory URL QR code:



Tools Needed

- Torque driver / wrench (e.g., 5 - 25 in-lbs).
- T10 Torx bit for installing Aimpoint ACRO.
- T15 Torx bit for installing the adapter plate.

1. Install Adapter Plate

- Affix adapter plate (1) to Leupold ring top in the desired position.
The plate can be installed on either side at 45° angle or directly on top.
The plate features multiple holes, so it can be placed farther forward or back.
- Once the desired position is determined, insert screws (2). Torque to 25 in-lbs.

2. Install Aimpoint ACRO Sight

- With the ACRO recoil stop positioned in the recess, push the sight forward and tighten the locking bar screw.
- Tighten the locking bar screw until light resistance is encountered.
Proceed with another 1/4 - 1/2 turn until fully tightened (torque to <=26 in-lbs).
- Retighten the locking bar screw after initial firing to ensure sight is securely fastened.

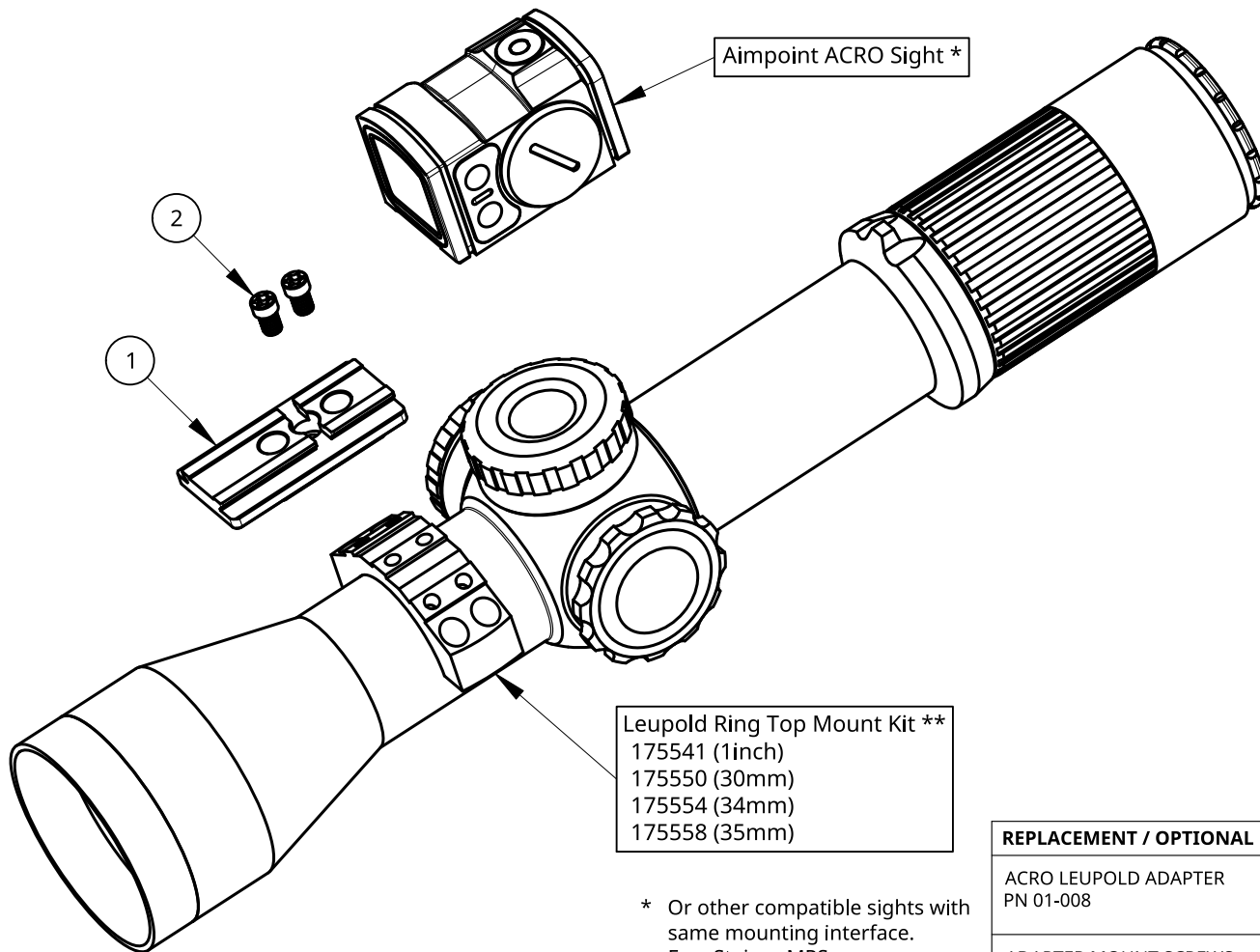

Leupold Ring Top Mount Kit **
 175541 (1inch)
 175550 (30mm)
 175554 (34mm)
 175558 (35mm)

REPLACEMENT / OPTIONAL PARTS

ACRO LEUPOLD ADAPTER
PN 01-008



ADAPTER MOUNT SCREWS
PN 10-006



* Or other compatible sights with same mounting interface.
E.g., Steiner MPS.

** Purchased separately.

AR15 / M4 HEIGHT OVER BORES

w/ 1.54" SCOPE MOUNT
 MK6 3-18X: 2.74"
 ACRO: 4.45"

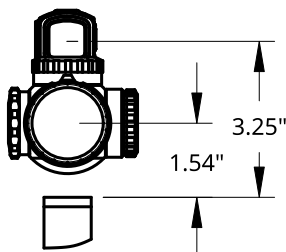
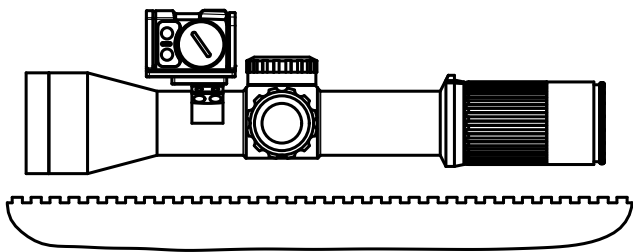

	NAME	DATE
DRAWN	KOENG.CO	09/16/2024
CHECKED		
APPROVED		
MATERIAL	6061-T6	FINISH Mil. Spec Type 3 Anodized



TITLE		
ACRO LEUPOLD ADAPTER PN 01-008		
SIZE A	DWG NO. 20240920	REV. 02
SCALE 1:1.5	WEIGHT 16.16g / .57oz	SHEET 1 of 1